

Hyperion LED Modules Specification Sheet

Low Voltage Sign Lighting



Optical Data	
Wattage	0.72-1.6W/module
Input Voltage	12VDC
Luminous Efficacy	29-160lm/W
CCT	6000K & RGB Available
Beam Angle	160°
Warranty	3-5 Years
Installation	Ideal for 3.14-7.87"

About

The Eco Lighting Solutions Hyperion LED Modules offer high efficiency and high output without the additional power draw. Increase traffic and maximize visibility for your business today.

Applications:

- ◆ Sign Cans
- ◆ Channel Letters
- ◆ Light Boxes
- ◆ Landscape Lighting



Specifications

	2LED	3LED	4LED	RGB
Chip Size	2835	2835	2835	5050
W/module	0.72W/module	1W/module	1.6W/module	0.72W/module
Lm/W	129lm/W	128lm/W	160lm/W	29lm/W
Cascade	100/pack, 2 lengths of 50	100/pack, 2 lengths of 50	50/pack, 2 lengths of 25	50/pack, 2 lengths of 25
IP Rating	IP65	IP65	IP65	IP65
CCT	6000K	6000K	6000K	RGB
Module Dimensions	49*16*6	70*16*6	49*39*7.5	70*16*11.2
Module Spacing	3.46"	4.53"		5.1"

2LED Dimensions

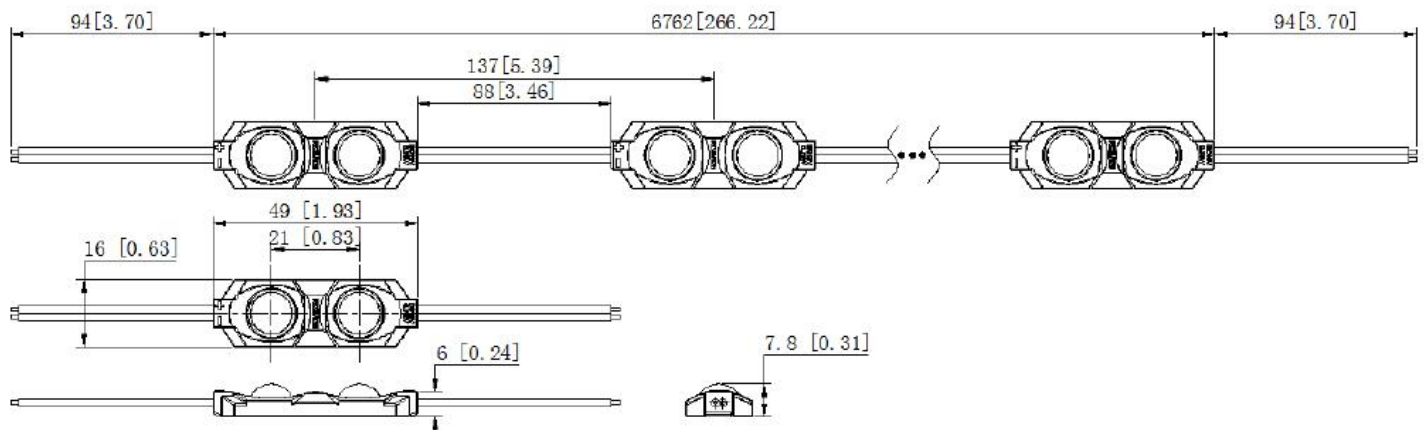

3LED Dimensions

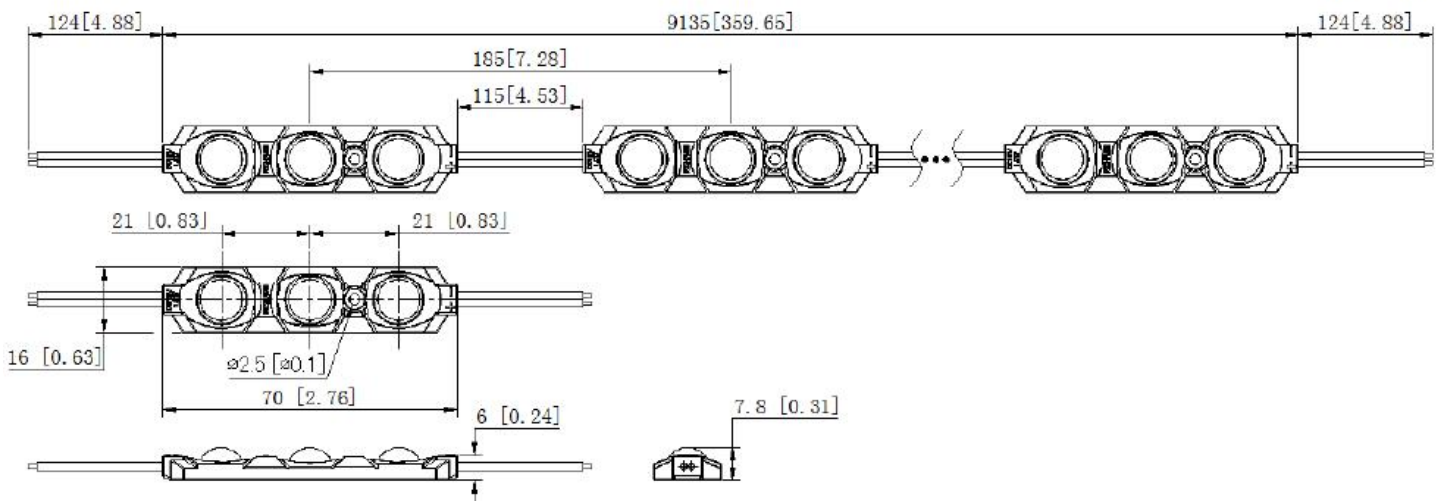

4LED Dimensions

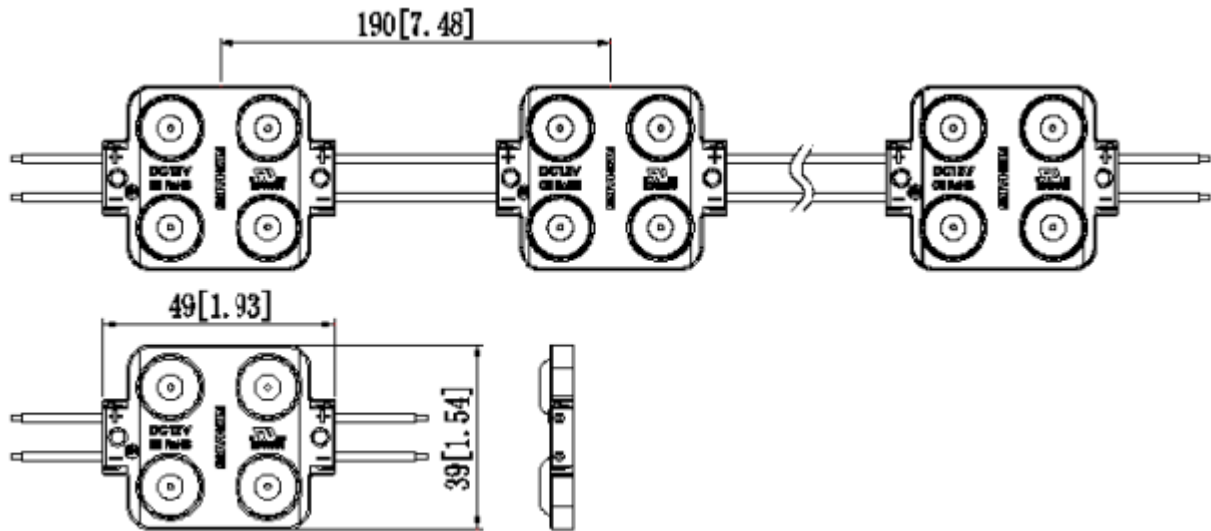

RGB Dimensions

Unit: mm[inch]

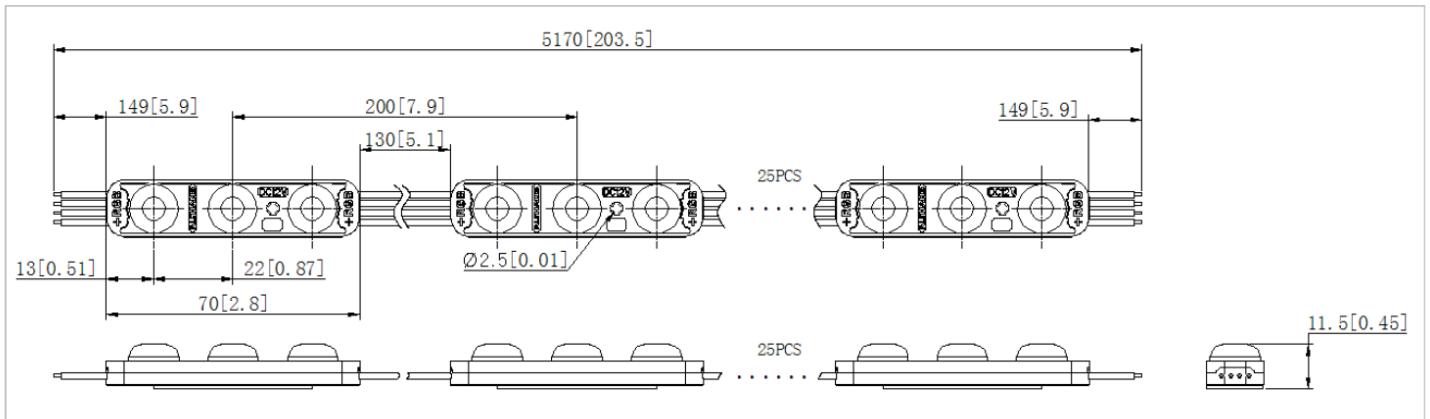

**If you have any questions
Please call or visit our showroom**

#4 2015 32 Ave NE
Calgary, AB
T2E 6Z3
1-877-627-0251
info@ecolighting.ca

All products should be installed by a qualified technician in
accordance with the Canadian Electrical Code



#4 2015 32Ave NE | 403-208-0251 | info@ecolighting.ca | www.ecolighting.ca